



THE INN AT  
DROMOLAND



The Inn at Dromoland offers a fantastic solution for your next Company Meeting / Conference. The benefit of booking with us is that you will have your delegate's undivided attention. We are located on 450 acres of Parkland, with ample complimentary car parking, and easy access just off Exit 11 on the M18 Limerick to Galway road.

Our aim is to ensure that you and your delegates get to experience the highest level of service, along with exceptional facilities, to ensure that you have an event that will be the talk of your company for years to come!

Our Conference and Meeting rooms all offer natural daylight, WiFi access, a wide variety of styles and configurations. The Ballyhannon Suite is our main conference room and can accommodate up to 220 Classroom Style, while our Sun Lounge, Patio Room and Boardroom offer the ideal break out rooms.

With its close proximity to both Shannon International Airport, Limerick & Galway City, The Inn at Dromoland is the perfect place to do business in the Shannon region.

*Your Perfect Meetings and Events Venue*



### ***Conference Room Hire Charges***

*All of our Conference Rooms offer Natural Daylight and Air Conditioning*

<b>Ballyhannon Suite</b>	€ 450.00 per day / €250 Half Day
	Facilities include large Screen with full AV system including LCD Projector, DVD & Video System
<b>Sun Lounge</b>	€ 150.00 per day / €100 Half Day
<b>Boardroom</b>	€ 120.00 per day / €70 Half Day
<b>The Patio</b>	€ 200.00 per day / €120 Half Day

Please note that we require a valid company credit card to guarantee any booking. Cancellations of Meeting Rooms 72 hours or more in advance no charge applies. Within 72 Hours full Meeting Room Hire price will be charged.

### ***Accommodation Rates***

Discounted group conference rates can be discussed when specific dates and numbers have been established.

### ***Conference Dining***

Specific menus and pricing can be created by our expert team of chefs to suit your event's individual requirements and budget.

We have a variety of options available for breaks, lunches and dinners to meet all of your needs. All dietary requirements and special requests can be catered for.

*Your Perfect Meetings and Events Venue*



THE INN AT  
DROMOLAND

*Conference Meeting Room Options*

***Ballyhannon Suite***



*Length 97'*

*Width 38'*

*Height 14'*

*Classroom 220*

*Theatre 350*

*Dining 280*

*U Shape 80*

*Boardroom 80*

***The Sun Lounge***

*Length 44'*

*Width 24'*

*Height 10'*

*Classroom 30*

*Theatre 50*

*Dining 45*

*U Shape 25*

*Boardroom 25*



***Boardroom***

*Your Perfect Meetings and Events Venue*



THE INN AT  
DROMOLAND

*Length 26'*  
*Width 13'*  
*Height 12'*  
*Boardroom 12*



### ***Dining Options / Exhibition Space***

#### ***The Patio Room***

*Length 40'*  
*Width 39'*  
*Height 9'*  
*Classroom 60*  
*Theatre 120*  
*Dining 80*  
*U Shape 30*  
*Boardroom 40*

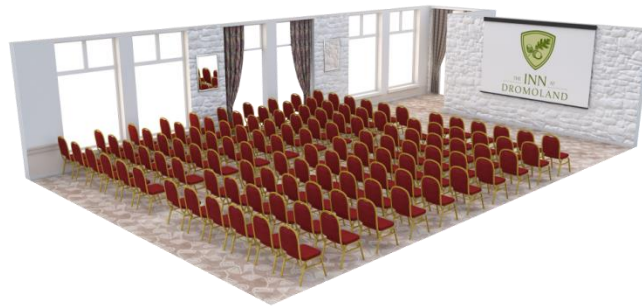

*Your Perfect Meetings and Events Venue*



THE INN AT  
DROMOLAND

***Our Outdoor Space for Team Building / Al Fresco***

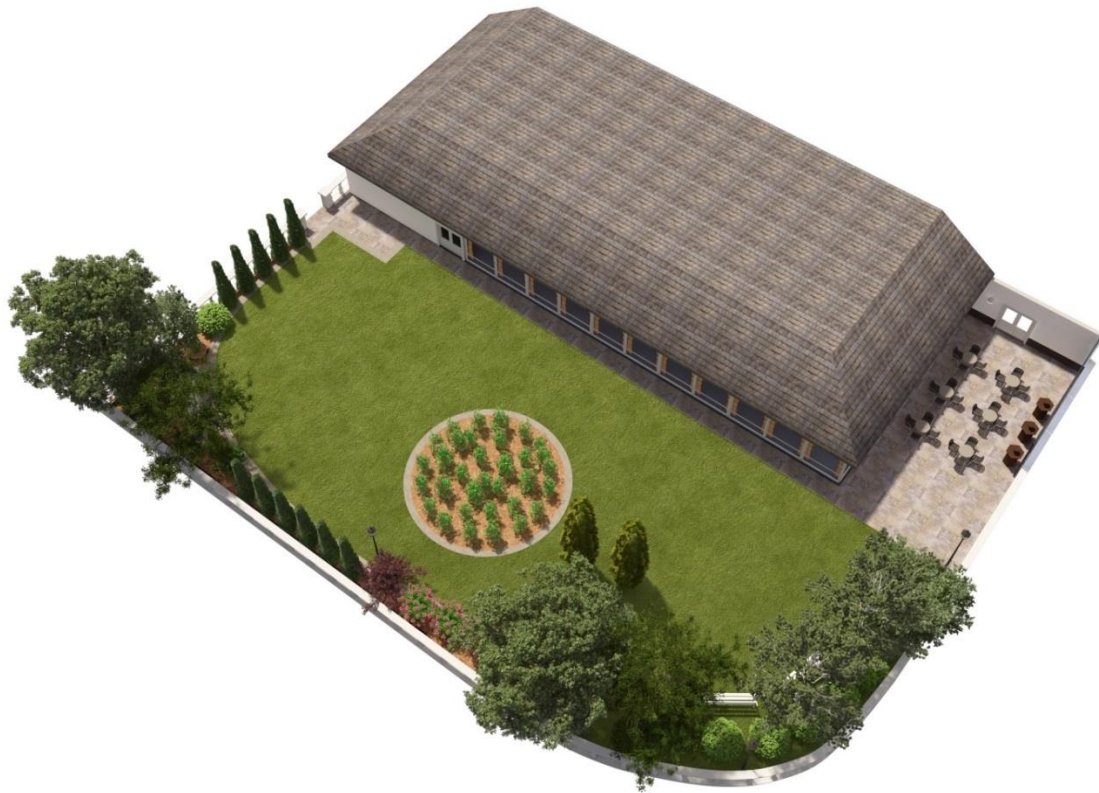

***Whatever your requirements, we have the space to suit.***

***Contact us today for a tailor made quote.***

Dermot Hogan  
Sales & Marketing Manager  
The Inn at Dromoland



061 368161



[dermot.hogan@theinnatdromoland.ie](mailto:dermot.hogan@theinnatdromoland.ie)



[www.theinnatdromoland.ie](http://www.theinnatdromoland.ie)

*Your Perfect Meetings and Events Venue*